

0.4" Single Digit Display

FEATURES

- 0.4" digit height
- Right hand decimal point
- Additional colors/materials available

OPTO-ELECTRICAL CHARACTERISTICS (Ta = 25°C)

PART NO.	PEAK WAVE LENGTH (nm)	EMITTED COLOR	FACE COLORS		MAXIMUM RATINGS			OPTO-ELECTRICAL CHARACTERISTICS								PIN-OUT
			SURFACE COLOR	EPOXY COLOR	IF (mA)	VR (V)	PD (mW)	VF(V)			IR(μA)		IV(μcd)			
								typ.	max.	@mA	max.	@VR	typ. per seg.	@mA		
MTN2140-AG	567	Green	Grey	White	30	5	85	2.1	3.0	20	100	5	2900	10	1	
MTN4140-AO	635	Orange	Grey	White	30	5	85	2.1	3.0	20	100	5	3300	10	1	
MTN4140-AHR	635	Hi-Eff Red	Red	Red	30	5	85	2.1	3.0	20	100	5	3300	10	1	
MTN7140M-11A	660	Ultra Red	Grey	White	30	4	70	1.7	2.2	20	100	4	17300	20	1	
MTN2140-CG	567	Green	Grey	White	30	5	85	2.1	3.0	20	100	5	2900	10	2	
MTN4140-CO	635	Orange	Grey	White	30	5	85	2.1	3.0	20	100	5	3300	10	2	
MTN4140-CHR	635	Hi-Eff Red	Red	Red	30	5	85	2.1	3.0	20	100	5	3300	10	2	
MTN7140M-11C	660	Ultra Red	Grey	White	30	4	70	1.7	2.2	20	100	4	17300	20	2	

Operating Temperature: -25~+85, Storage Temperature: -25~+100. Other face/epoxy colors are available.

PACKAGE DIMENSIONS AND PIN FUNCTIONS

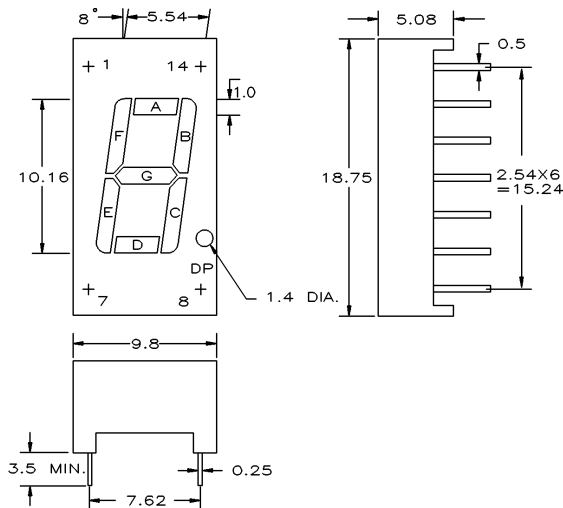

PINOUT 1

COMMON ANODE

PIN NO. FUNCTION

1. CATHODE A
2. CATHODE F
3. COMMON ANODE
4. NO PIN
5. NO PIN
6. NO CONNECTION
7. CATHODE E
8. CATHODE D
9. CATHODE DP
10. CATHODE C
11. CATHODE G
12. NO PIN
13. CATHODE B
14. COMMON ANODE

PINOUT 2

COMMON CATHODE

PIN NO. FUNCTION

1. ANODE F
2. ANODE G
3. NO PIN
4. COMMON CATHODE
5. NO PIN
6. ANODE E
7. ANODE D
8. ANODE C
9. ANODE DP
10. NO PIN
11. NO PIN
12. COMMON CATHODE
13. ANODE B
14. ANODE A

1. ALL DIMENSIONS ARE IN mm, TOLERANCE IS ± 0.25 mm UNLESS OTHERWISE SPECIFIED.
2. THE SLOPE ANGLE OF ANY PIN MAY BE $\pm 5.0^\circ$ MAX.



120 Broadway • Menands, New York 12204
Toll Free: (800) 98-4LED5 • Fax: (518) 432-7454

For up-to-date product info visit our web site at www.marktechopto.com

All specifications subject to change.